



2 HENRY ADAMS

±313,000 SF
SAN FRANCISCO'S
LARGEST BRICK &
TIMBER OFFERING
60,000 SF OFFICE
166,000 SF R&D/LAB

DAVE YOUNG

+1 415 773 3523
dave.young@cushwake.com
Lic. 01752874

JD LUMPKIN

+1 415 658 3648
jd.lumpkin@cushwake.com
Lic. 01215057

MARC POPE

+1 650 619 2981
marc.pope@cushwake.com
Lic. 01474483

2henryadams.com

3rd FLOOR
±73,028 RSF AVAILABLE NOW

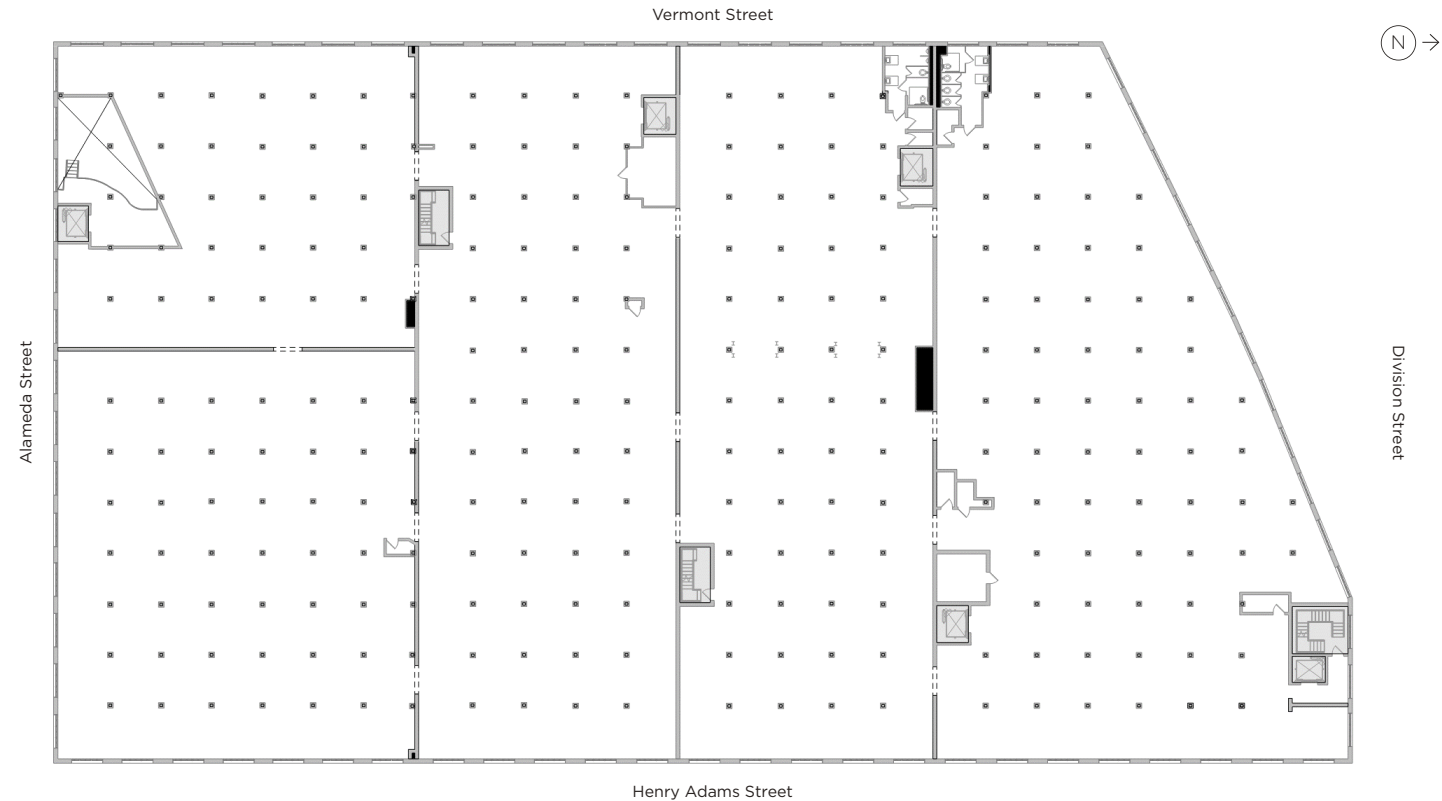

©2022 Cushman & Wakefield. All rights reserved. The information contained in this communication is strictly confidential. This information has been obtained from sources believed to be reliable but has not been verified. NO WARRANTY OR REPRESENTATION, EXPRESS OR IMPLIED, IS MADE AS TO THE CONDITION OF THE PROPERTY (OR PROPERTIES) REFERENCED HEREIN OR AS TO THE ACCURACY OR COMPLETENESS OF THE INFORMATION CONTAINED HEREIN, AND SAME IS SUBMITTED SUBJECT TO ERRORS, OMISSIONS, CHANGE OF PRICE, RENTAL OR OTHER CONDITIONS, WITHDRAWAL WITHOUT NOTICE, AND TO ANY SPECIAL LISTING CONDITIONS IMPOSED BY THE PROPERTY OWNER(S). ANY PROJECTIONS, OPINIONS OR ESTIMATES ARE SUBJECT TO UNCERTAINTY AND DO NOT SIGNIFY CURRENT OR FUTURE PROPERTY PERFORMANCE.